



ENSEAL® G2 Articulating

A turning point in vessel sealing

ETHICON

PART OF THE *Johnson & Johnson* FAMILY OF COMPANIES

Better surgery for a better world

Enseal

ENSEAL® G2 Articulating Seals like no other

Unparalleled approach to superior sealing

- Facilitates a perpendicular approach to vessels through **110° of articulation** with **full 360° shaft rotation**
- Vessels sealed with a **perpendicular approach** are more than **28% stronger** than vessels sealed at a 45° angle¹
- Helps capture vessels in one bite

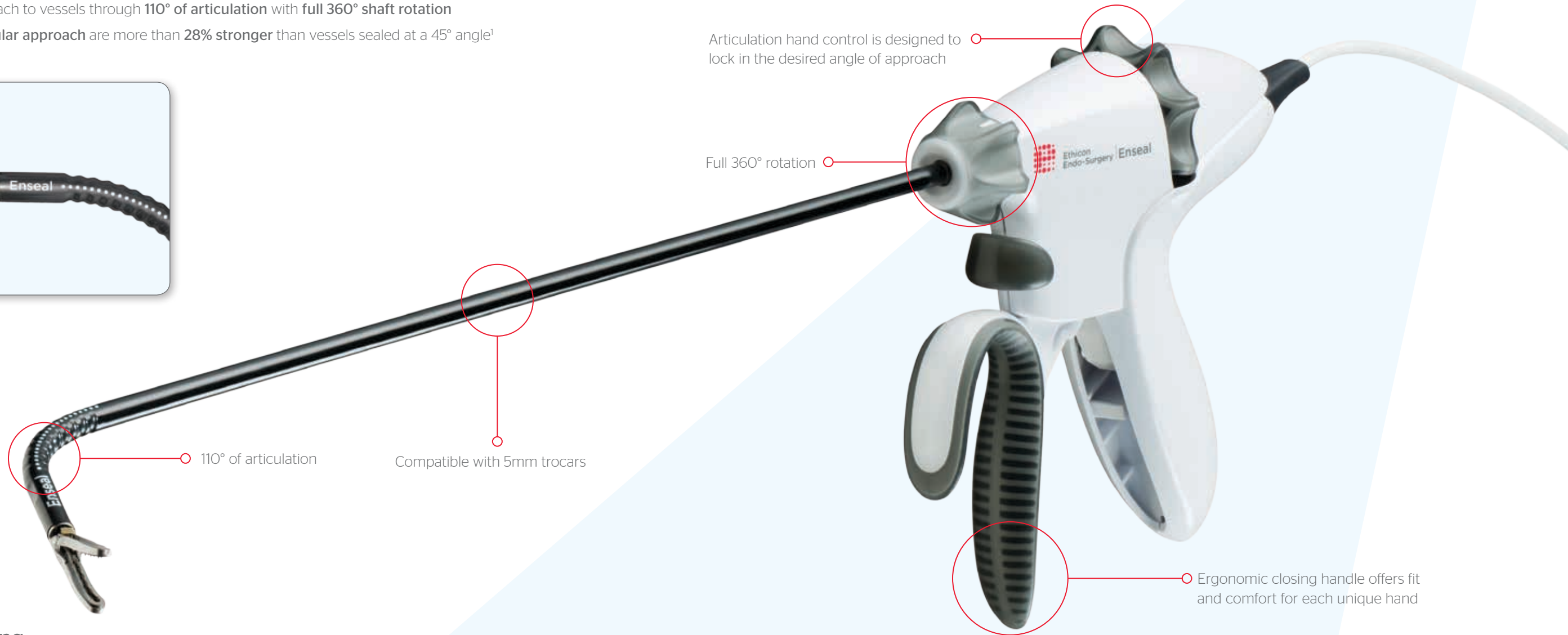
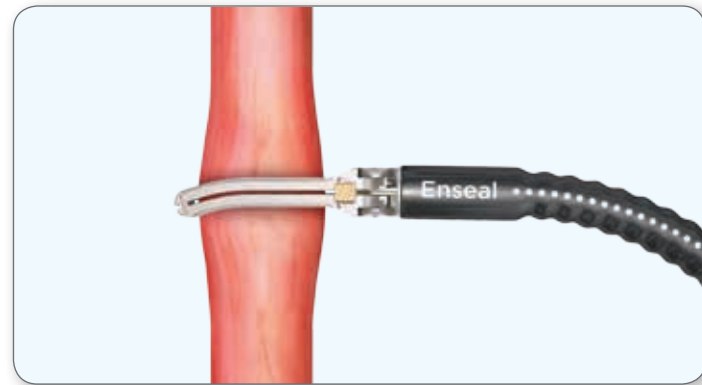

Unmatched maneuvering for better access

- Provides the ability to **maneuver** around corners and behind structures
- Provides **access** to tissue in deep or tight spaces for greater control of the angle of approach to vessels²
- May reduce the amount of tissue manipulation needed to access a targeted area²



Unsurpassed tissue-sealing technology

SECURE

- Seals and cuts vessels up to 7mm diameter as well as lymphatics³
- I-BLADE® delivers high uniform compression to ensure a strong seal

GENTLE

- Temperature regulating PTC material is designed to minimize sticking
- Offset electrode configuration is designed to minimize thermal spread

ETHICON
PART OF THE *Johnson & Johnson* FAMILY OF COMPANIES

Better surgery for a better world

Enseal

ENSEAL® G2 Tissue Sealers

Seals like no other



ENSEAL® G2 Articulating Curved

CODE	SHAFT DIAMETER	SHAFT LENGTH	QTY
NSLG2C35A	5mm	35cm	6
NSLG2C45A	5mm	45cm	6



ENSEAL® G2 Articulating Straight

CODE	SHAFT DIAMETER	SHAFT LENGTH	QTY
NSLG2S35A	5mm	35cm	6
NSLG2S45A	5mm	45cm	6



ENSEAL® G2 Curved

CODE	SHAFT DIAMETER	SHAFT LENGTH	QTY
NSLG2C14	5mm	14cm	6
NSLG2C25	5mm	25cm	6
NSLG2C35	5mm	35cm	6
NSLG2C45	5mm	45cm	6



ENSEAL® G2 Straight

CODE	SHAFT DIAMETER	SHAFT LENGTH	QTY
NSLG2S14	5mm	14cm	6
NSLG2S25	5mm	25cm	6
NSLG2S35	5mm	35cm	6
NSLG2S45	5mm	45cm	6



ENSEAL® G2 Super Jaw

CODE	SHAFT DIAMETER	SHAFT LENGTH	QTY
ENSEALX22L	12mm	22cm	6



The complete ENSEAL® G2 Tissue Sealer portfolio

All ENSEAL® and HARMONIC® devices are compatible with the Ethicon Endo-Surgery Generator.

To experience ENSEAL® G2 Articulating and other ENSEAL® G2 Tissue Sealers,

Contact your Ethicon Sales Professional

Call 1-877-ETHICON

Connect at <http://www.ethicon.com/enseal-g2-articulating>

1. ENSEAL® devices tested in a benchtop study on 5-7mm porcine carotid arteries. With NSLG2C35A devices, median burst pressures were 51% higher for vessels sealed at a 90° angle compared to vessels sealed at a 45° angle ($P=0.0007$). With NSLG2S35A devices, mean burst pressures were 29% higher for vessels sealed at a 90° angle compared to vessels sealed at a 45° angle ($P=0.001$).

2. Compared to a non-articulating device.

3. Ethicon Endo-Surgery internal study PSP003113. Studies conducted on porcine mesentery.

ETHICON

PART OF THE *Johnson & Johnson* FAMILY OF COMPANIES

Ethicon Endo-Surgery, Inc.
a Johnson & Johnson company

Better surgery for a better world

©2013 Ethicon Endo-Surgery, Inc. All Rights Reserved. DSL 13-0841

Enseal